

FITTING PLATES

P2346

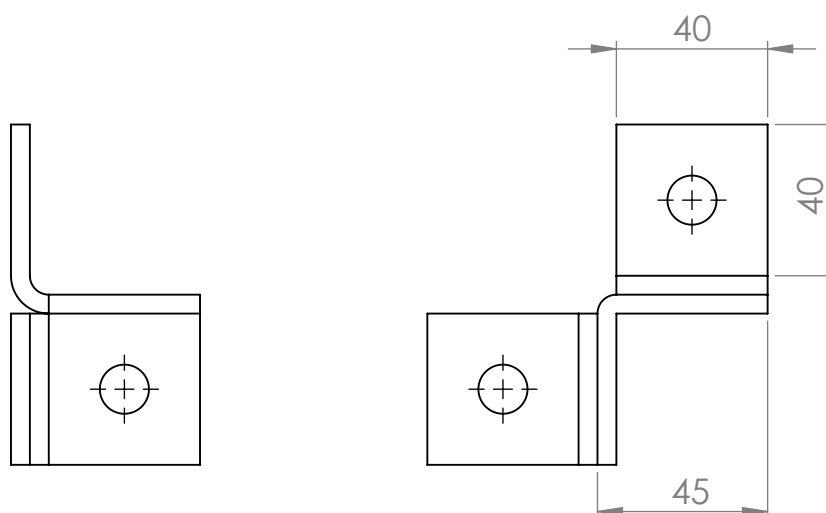
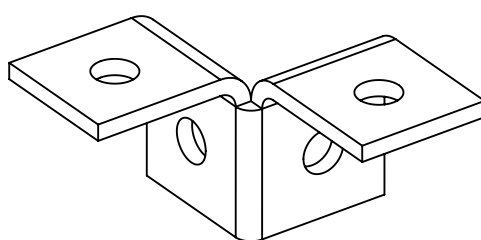

CODE	DESCRIPTION	THICKNESS[mm]	MATERIAL
P22235ZE	Double angular plate	5,0	ZE
P22236ZE	Double angular plate	6,0	ZE
P22235ZC	Double angular plate	5,0	ZC
P22236ZC	Double angular plate	6,0	ZC

Available also in Stainless steel A304 and A316

Legend:

ZE= GALVANIZED

ZC= HOT DIP GALVANIZED