

# FITTING PLATES

P1032

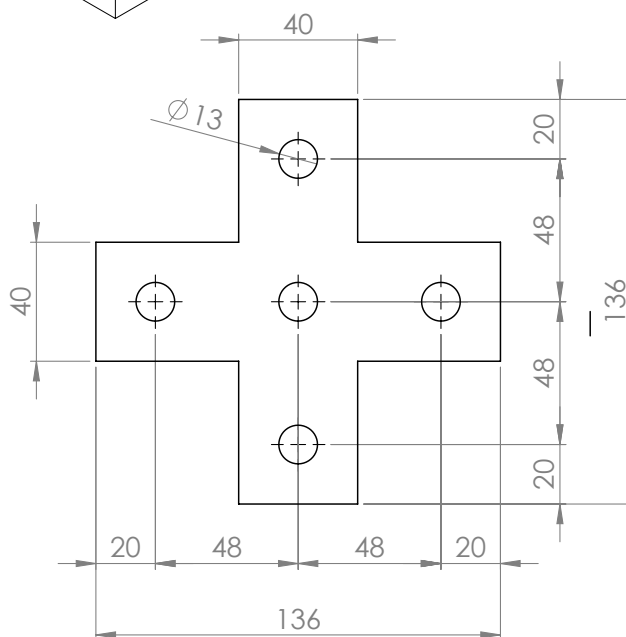
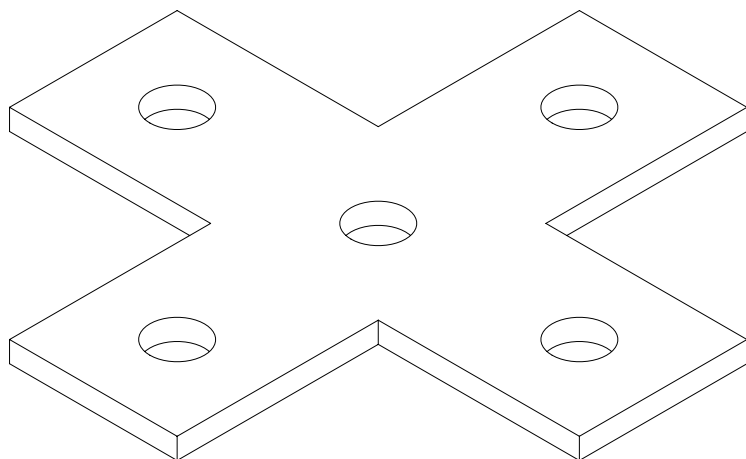

CODE	DESCRIPTION	THICKNESS[mm]	MATERIAL
P10325ZE	Flat Fitting	5,0	ZE
P10326ZE	Flat Fitting	6,0	ZE
P10325ZC	Flat Fitting	5,0	ZC
P10326ZC	Flat Fitting	6,0	ZC

Available also in Stainless steel A304 and A316

Legend:

ZE= GALVANIZED

ZC= HOT DIP GALVANIZED